

Guide Bushings

Steel, Punch Guide Bushings

SPECIFICATION

Type

- Type **C**: Without collar

Steel ST

- Hardened (HRC 62 +2)
- Fit surfaces d_1 and d_2 ground

INFORMATION

Guide bushings DIN 9845 are characterized by the tight dimensional and positional tolerances in connection with the hardened and finely machined surface. As a result, they are suitable for extremely universal use in many applications.

Bores with tolerance H7 are recommended to accommodate the bushings. In conjunction with the outer diameter of the guide bushing tolerated to n6, this results in a preferred transition fit.

ON REQUEST

- Other bores d_1

TECHNICAL INFORMATION

- ISO-Fundamental Tolerances (see page A21)

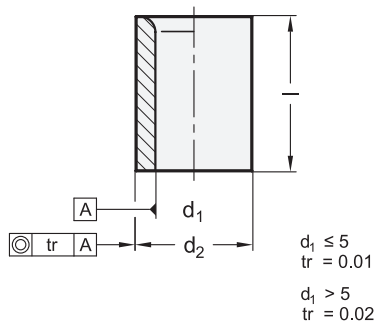

DIN 9845

Description	d_1 H7	Length l	d_2 n6	
DIN 9845-2-12-C-ST	2	12	6	2
DIN 9845-3-12-C-ST	3	12	7	3
DIN 9845-4-12-C-ST	4	12	8	4
DIN 9845-5-16-C-ST	5	16	10	7
DIN 9845-6-16-C-ST	6	16	12	10
DIN 9845-8-20-C-ST	8	20	15	20
DIN 9845-10-20-C-ST	10	20	18	28
DIN 9845-12-28-C-ST	12	28	22	58
DIN 9845-16-36-C-ST	16	36	30	141